

HA | Technical characteristics



Current carrying capacity

The current carrying is limited by maximum temperature of materials for inserts and contacts including terminals

Control and test procedures according to DIN EN 60512-5

Specifications

DIN EN 60 664
DIN EN 61 984

Inserts

Number of contacts 3,4,10,16,32(2X16)+PE

HZW-HA-003/004

10 A 230/400 V 4 KV 3

Working current
(See current carrying capacity)
Working voltage
Rated impulse voltage
Pollution degree

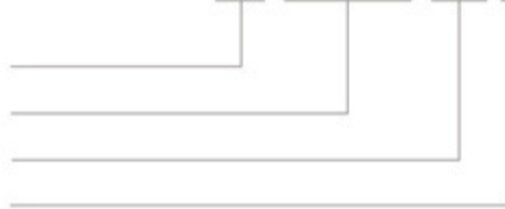

HZW-HA-010/016

16 A 250V 4 KV 3

Working current
(See current carrying capacity)
Working voltage
Rated impulse voltage
Pollution degree

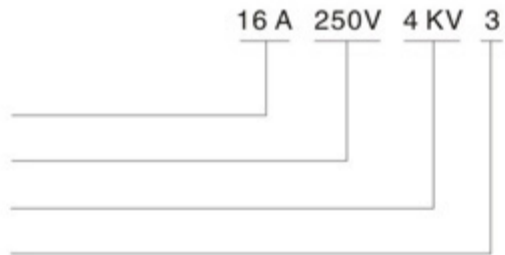

| | |
|--|-----------------------|
| Insulation resistance | $\geq 10^{10} \Omega$ |
| Material | Polycarbonate |
| Flammability acc.to(UL94) | VO |
| Limiting temperatures | -40°C~ +125°C |
| Mechanical working life(mating cycles) | ≥ 500 |
| Working voltage acc.to UL/CSA | 600V |

Contacts

| | |
|---------------------------|---|
| Material | copper alloy |
| Surface | Silver plated |
| Contact resistance | $\leq 1m\Omega$ |
| Terminal | Screw terminal |
| Wire gauge | 1.0-2.5mm ² (AWG18-14) |
| Screw terminal tightening | (HA-003/004) 0.25Nm (HA-010/016) 0.5Nm |

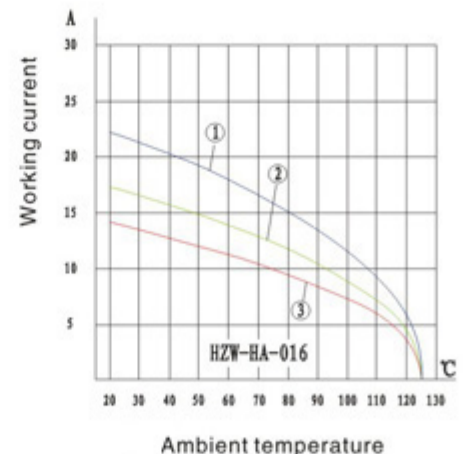
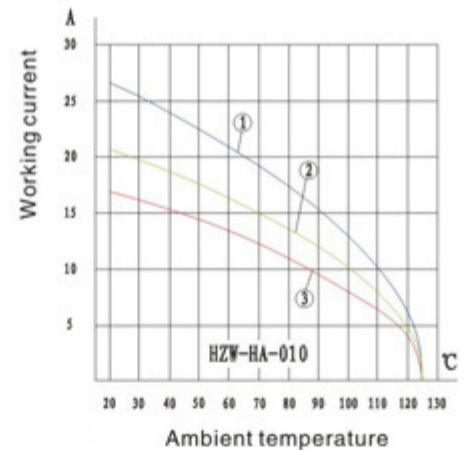
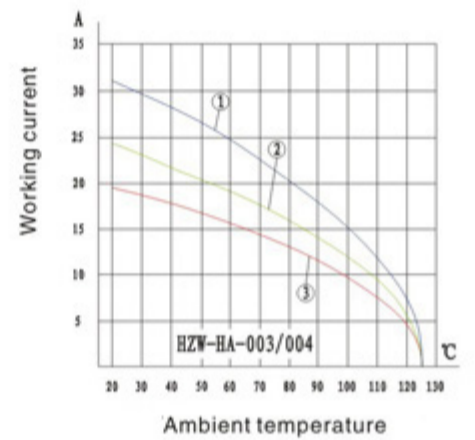

- 1 wire gauge:2.5mm²
- 2 wire gauge:1.5mm²
- 3 wire gauge:1.0mm²

HA

Hzw-HA

Insert 230/400V 10A

Number of contacts

3 +



Mounting example

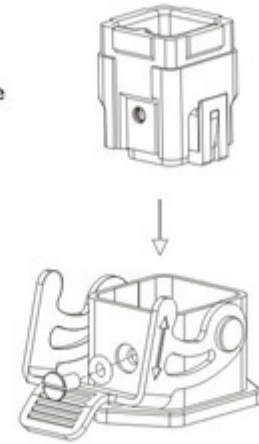

TYPE
Part number
Hoods/Housings

HZW-HA-003-M
61 201 003 101
Size HZW-H3A

HZW-HA-003-F
61 201 003 102
Size HZW-H3A

Drawing (Dimensions in mm)

Male insert (M)

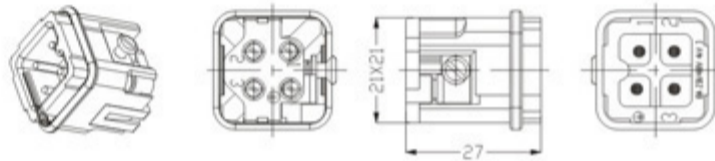

Female insert (F)

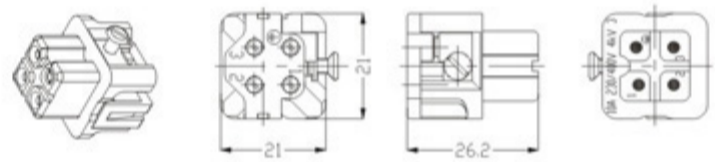

Panel cut out

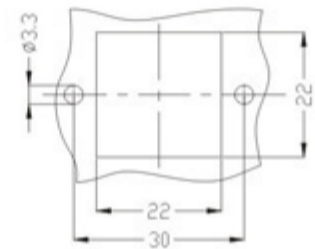

Note: Suit hood/housings:Size H3A
Hood/Housing detail on "Hood/Housing" section

Hzw-HA

Insert 230/400V 10A

Number of contacts

4 +



Mounting example

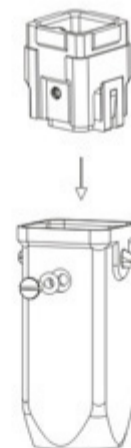

TYPE
Part number
Hoods/Housings

HZW-HA-004-M
61 201 004 111
Size HZW-H3A

HZW-HA-004-F
61 201 004 112
Size HZW-H3A

Drawing (Dimensions in mm)

Male insert (M)

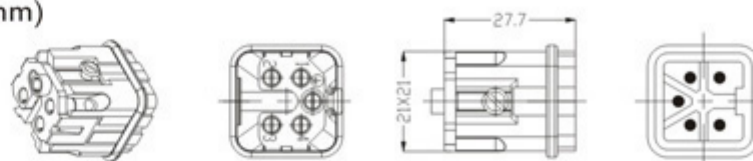

Female insert (F)

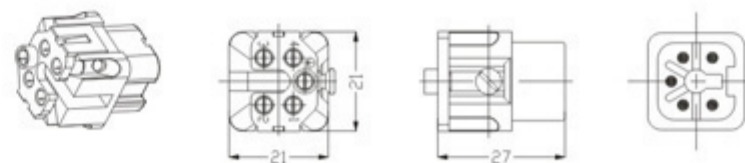

Panel cut out

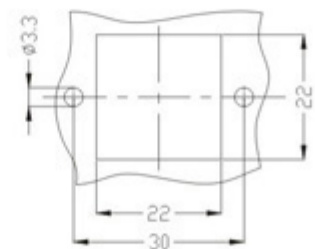

Note: Suit hood/housings:Size H3A
Hood/Housing detail on "Hood/Housing" section

Hzw-HA

Insert 250 V 16A

Number of contacts

10, 16, 32 +

HA

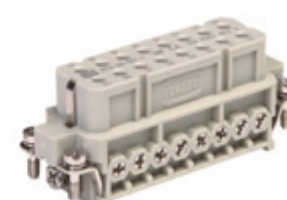

TYPE
Part number
Hoods/Housings

HZW-HA-010-M
61 201 010 121
Size HZW-H10A

HZW-HA-010-F
61 201 010 122
Size HZW-H10A

HZW-HA-016-M
61 201 016 131
Size HZW-H16A

HZW-HA-016-F
61 201 016 132
Size HZW-H16A



TYPE
Part number
Hoods/Housings

HZW-HA-032-M
61 201 032 141
Size HZW-H32A

HZW-HA-032-F
61 201 032 142
Size HZW-H32A

Drawing (Dimensions in mm)

Male insert (M)

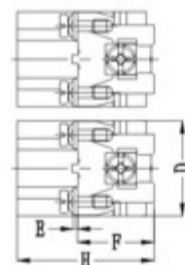
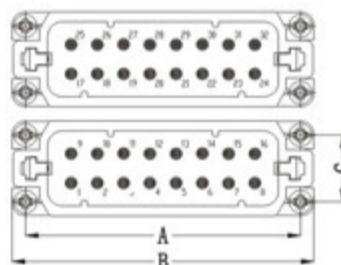
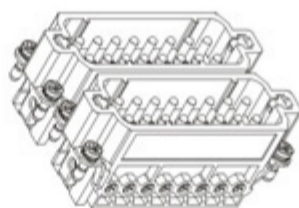

Male insert(M)

| number of contacts | A | B | C | D | E | F | H |
|--------------------|------|------|----|------|---|------|----|
| HZW-HA-010 | 49.5 | 56 | 16 | 22.8 | 1 | 18.4 | 33 |
| HZW-HA-016 | 66 | 72.4 | 16 | 22.8 | 1 | 18.4 | 33 |
| HZW-HA-032 | 66 | 72.4 | 16 | 22.8 | 1 | 18.4 | 33 |

Female insert (F)

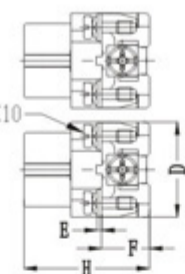
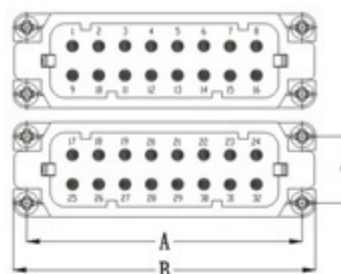
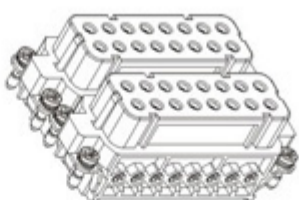

Female insert(F)

| number of contacts | A | B | C | D | E | F | H |
|--------------------|------|------|----|------|---|------|----|
| HZW-HA-010 | 49.5 | 56.5 | 16 | 22.8 | 1 | 11.5 | 30 |
| HZW-HA-016 | 66 | 72.4 | 16 | 22.8 | 1 | 11.5 | 30 |
| HZW-HA-032 | 66 | 72.4 | 16 | 22.8 | 1 | 11.5 | 30 |

Panel cut out

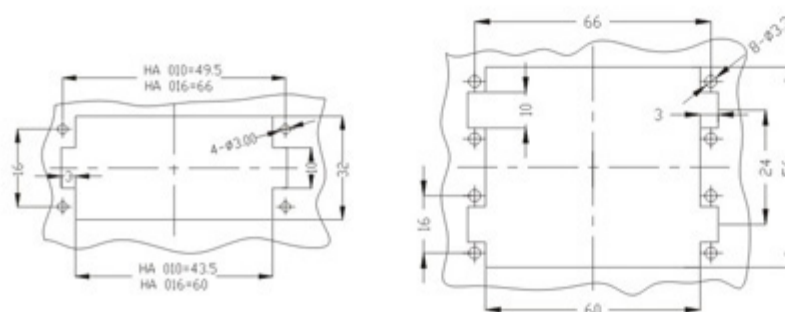

Note: Suit hood/housings: Size H10A, H16A, H32A

Hood/Housing detail on "Hood/Housing" section